

## [ Niche Shelf ]

### Drawing reference for fixture installation

S=1/20, 1/2 (A3)

#### Benefits:

- 12mm diameter dotless line lighting fixture with lens distribution
- Lens specifications that distribute light with an approximate 40° angle, providing beautiful light gradation
- Light distribution can be adjusted in 10° increments after installation with clips
- Available in 60 sizes from 33 mm to 1508 mm, connecting spot is not easily noticeable

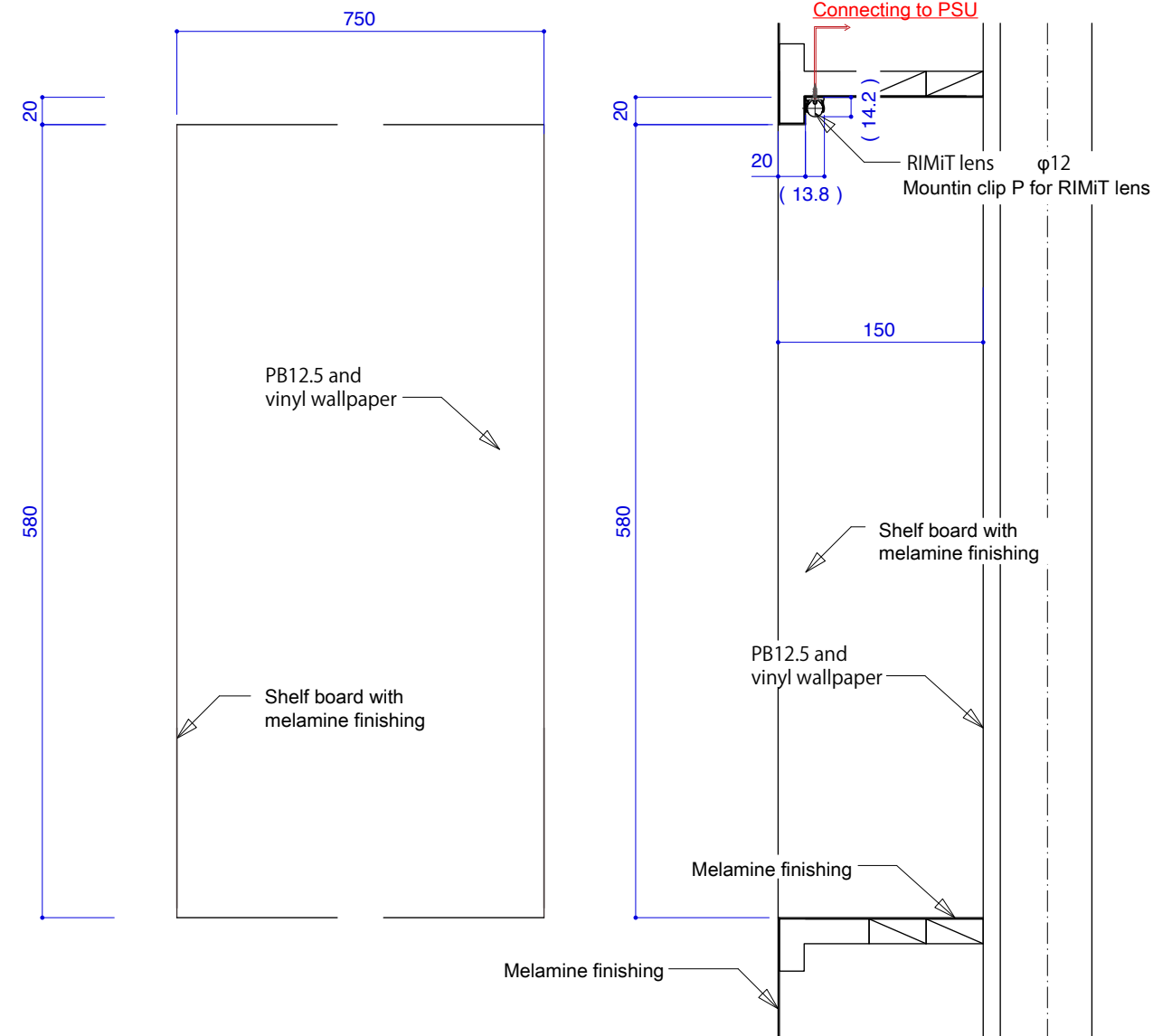

### Dimension of opening for installing connectors S=1\*2

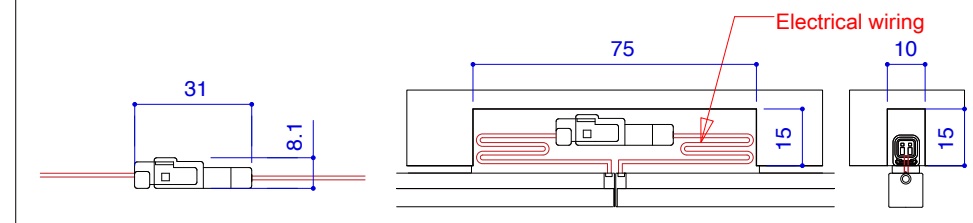

### Side section detail drawing S=1:2

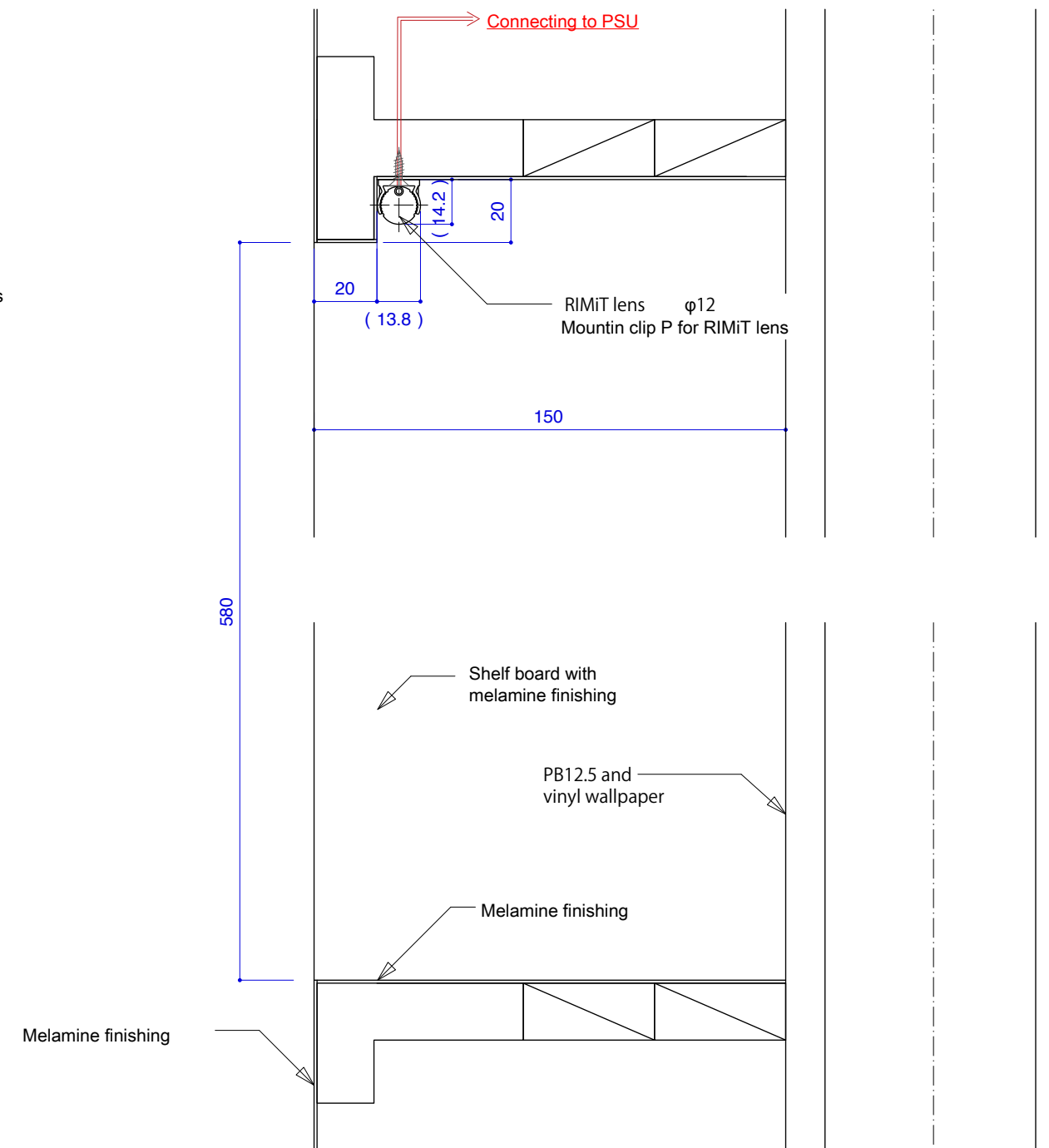

Benefits:

- 12mm diameter dotless line lighting fixture with lens distribution
- Lens specifications that distribute light with an approximate 40° angle, providing beautiful light gradation
- Light distribution can be adjusted in 10° increments after installation with clips
- Available in 60 sizes from 33 mm to 1508 mm, connecting spot is not easily noticeable

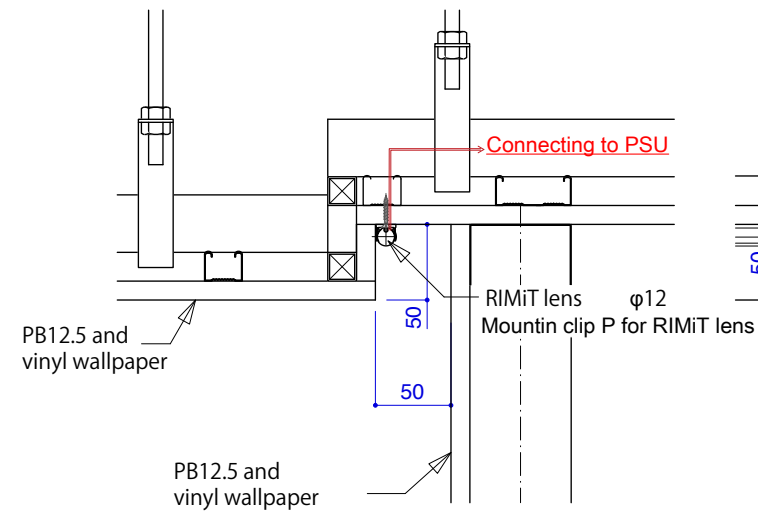

Side section detail drawing S=1:2

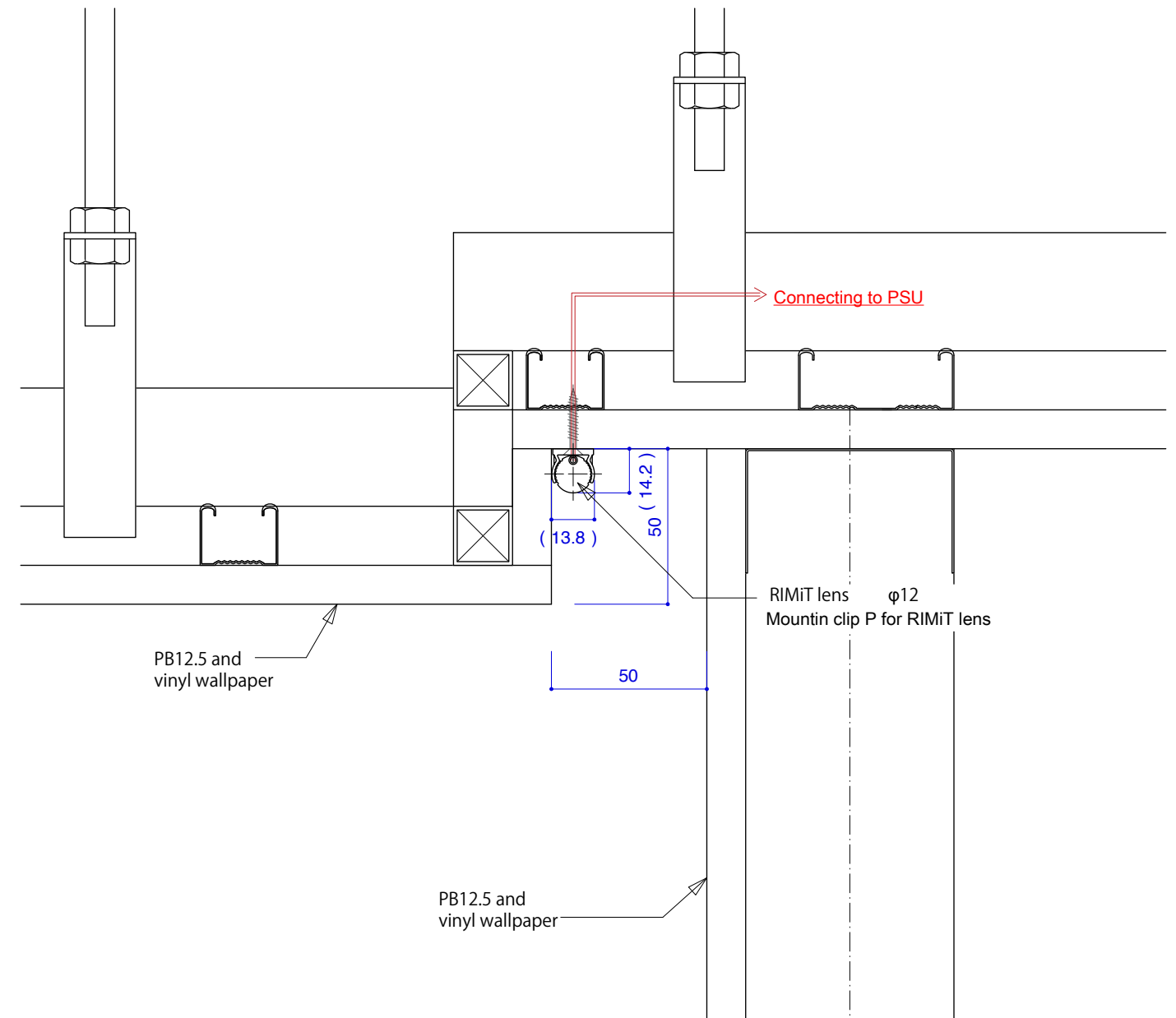
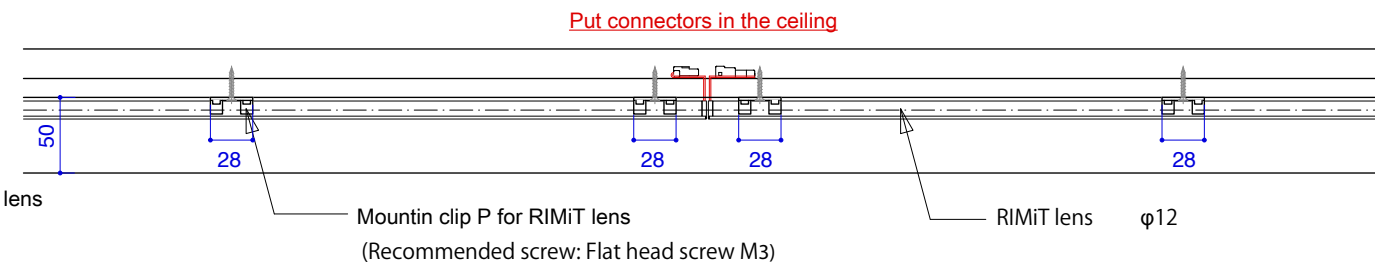

# [ Curtain Box ]

## Drawing reference for fixture installation

S=1/5, 1/2 (A3)

### Benefits:

- 12mm diameter dotless line lighting fixture with lens distribution
- Lens specifications that distribute light with an approximate 40° angle, providing beautiful light gradation
- The lift parts create space for wiring storage when connected
- Available in 60 sizes from 33 mm to 1508 mm, connecting spot is not easily noticeable

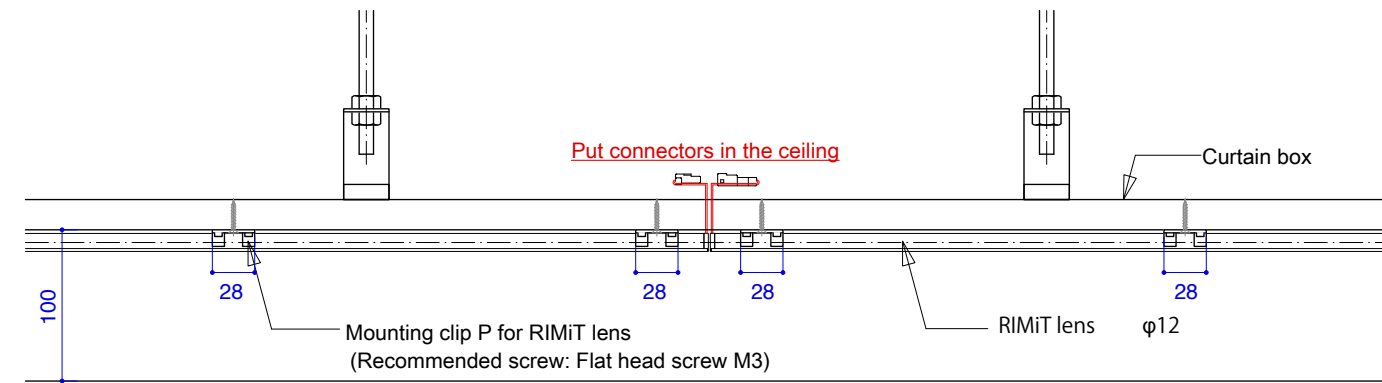
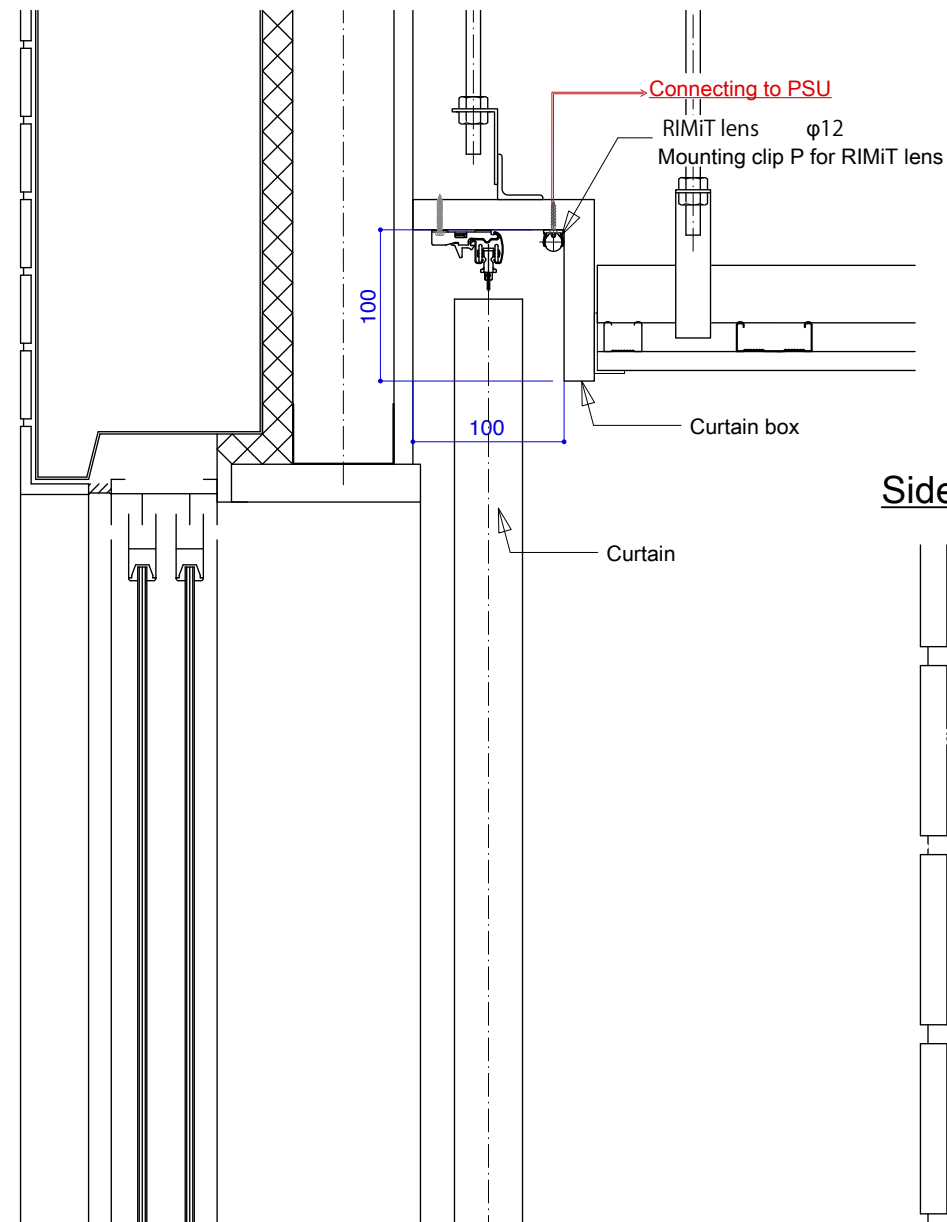

## Side section detail drawing S=1:2

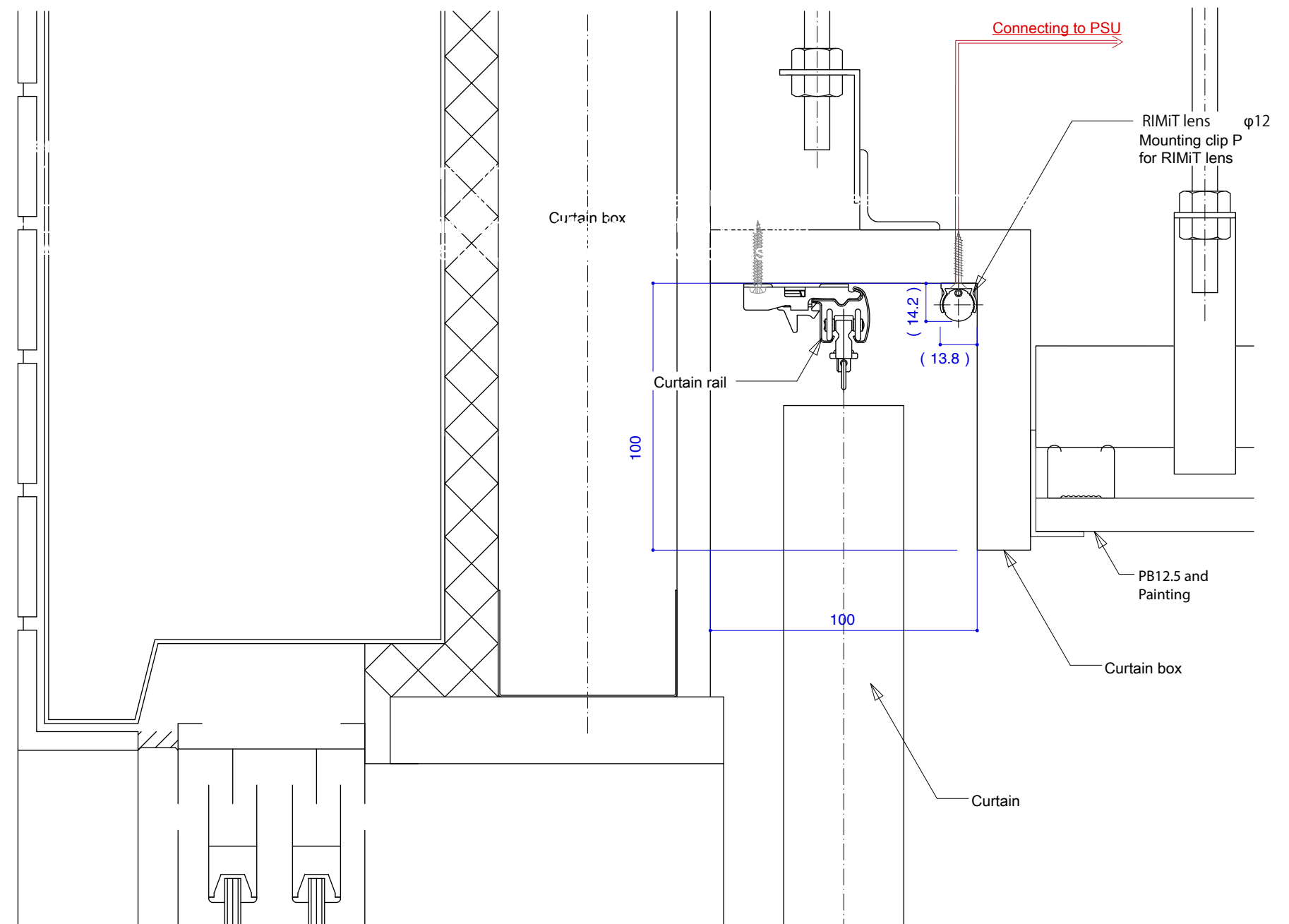

# [ Uplight for Wainscot ]

## Drawing reference for fixture installation

S=1/5, 1/2 (A3)

### Benefits:

- 12mm diameter dotless line lighting fixture with lens distribution
- Lens specifications that distribute light with an approximate 40° angle, providing beautiful light gradation
- The lift parts create space for wiring storage when connected
- Available in 60 sizes from 33 mm to 1508 mm, connecting spot is not easily noticeable

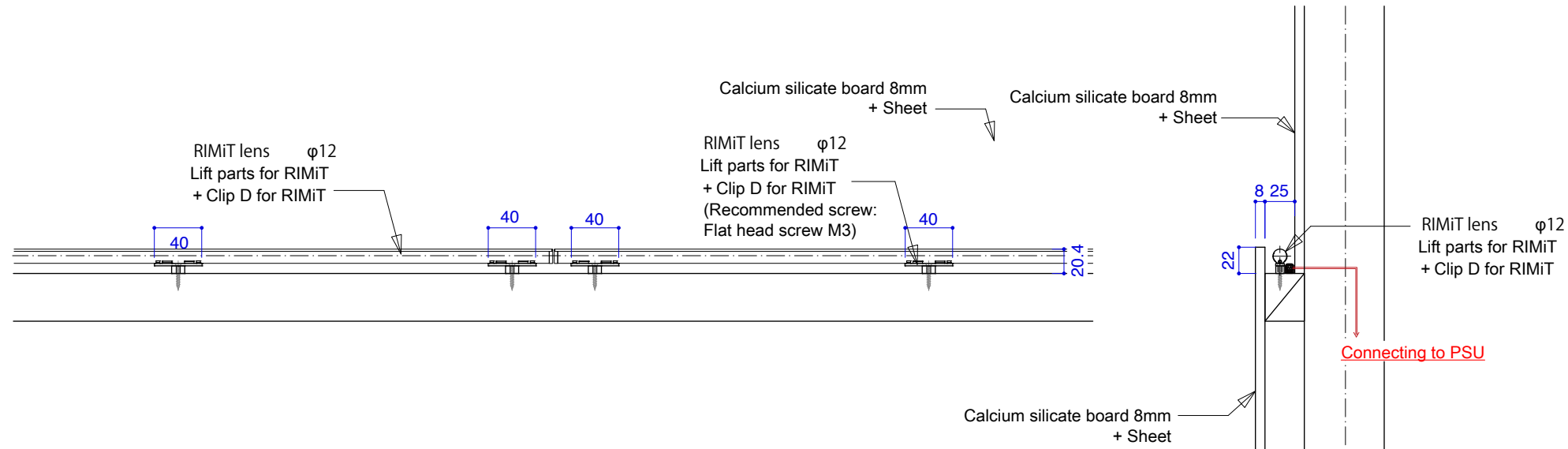

## Side section detail drawing S=1:2

