



Luci Power FLEX α Instruction Manual

Luci Pte. Ltd. Singapore World HQ
52A Tanjong Pagar Road, Singapore 088473
Tel: +65-6291-2410

Luci Co., Ltd. Tokyo Japan Regional HQ
Akasaka Bldg.F44-13-13, Akasaka, Minato-ku,
Tokyo 107-0052, Japan
Tel: +81-3-6327-7409 Fax: +81-3-6327-7410

Safety Cautions

The following is the safety cautions to prevent any harms or damages to others.
If the product is used against cautions, it may cause damages.



Electrical work certificate is needed to install and inspect this product.
Please ask electrician for the installation.



Please use DC24V power supply.
Do not use other power supplies such as AC220~240V.



Please turn off all the powers when installation and inspection.
Do not connect or disconnect the lead wires with its power on.



If the charges are in wrong direction,
electric resistances will become
hot and lighting will be destroyed.
Please connect the lead wires
with same color and insulate
with sleeve insulation tape
shrinkage tube.

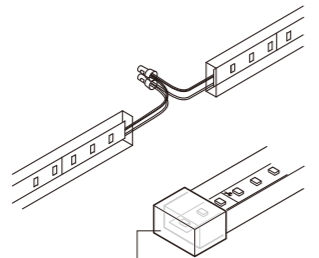

Endcap (Sold separately)



Do not place a heatable object such as a cloth or paper or an insulating material on
top of the lighting device or cover it with such a material. It may cause the device not
to turn on or fire.
Do not put a piece of metal or a flammable object in clearance of the lighting device.
The outline of the lighting device main unit must not contact equipment in or out of
the ceiling. It may cause fall, electric shock, or fire.
Do not operate the device with wet hands. It may result in an electric shock.



Important notice for storage
Observe the storing temperature of our light fittings: 0 °C to 55°C
Please do not store the carton or the packages of our light fittings in the following
conditions:
- wet location
- places of high humidity
- places with much litter or dust
- places of exposing against sun light directly
- places a solvent such as a paint liquid is stored

During storing period, please do not leave the cartons or individual packages
vertically.

Please do not open individual package until just before installing light fittings to
avoid any damage to the light fittings.

Please do not keep the carton in horizontally.
Please do not place heavy object on the carton.
Please do not use our light fittings as the working light during construction period.



When this product is cut,
please use endcaps to coat the surface.



Please rainproof using rainproof endcaps and
lead wire coating when this product is used outside.



This lamp fitting is for indoor use only.
Do not use in the following environments:

- A location at high temperature (+35°C or higher)
(usage environment temperature is 0°C to +35°C.)
- A location with high humidity.
- A dusty location.
- A location with corrosive or inflammable gases.
- A location where the product is exposed to direct sunlight.
- A highly airtight location.
- A location where the product is directly exposed to salt water or
organic solvents.
- A location subject to the effects of electric or magnetic fields.
- A location subject to intense vibration or shock, or a location sub
ject to continuous vibration.



Please do not do the followings to the product.
- Cut where there is no cut-mark
- Decompose or modify
- Pull or twist strongly
- Push strongly
- Bend more than the max angle



When there is abnormal situations, please cut off
the power immediately, consult with electricians,
and do not touch the lighting with hands.

Please read before the usage

- For safety, do not directly view the LED light source.
- The minimum allowable bend range of this lamp fitting is R300 mm.
Use the product under reasonable conditions.
- When the air temperature is low, the lamp fitting may become stiff.
Forcibly bending the fitting may cause damage. In this situation, it is recommended that you connect the lamp fitting to the power supply, turn on the light, wait
until it warms up, and then bend.
- When handling the product, take care not to bend or twist it.
This may cause malfunctioning. When mounting on a ceiling, under a shelf, or on a wall, mount tightly with no looseness or sagging.
- Use a mounting rail (option parts) to mount the lamp fitting in the mounting position.
- To mount the mounting rail in the mounting position, use mounting clips (option parts) and screws (commercially available).
- If you are using an instantaneous adhesive agent, wipe off all foreign matter, moisture, and oil from the mounting rail and mounting surface.
Dirt on the surfaces to be glued may cause the mounting rails to detach.
- The product has been manufactured with the utmost care; however, please understand that slight deviations in LED color are unavoidable due to the
characteristics of the product.

Maintenance and Inspection

- Lighting apparatus has a life span.
- Degradation occurs inside after 8-10 years of installation even when the apparatus looks fine from the outside.
Parts of the lighting apparatus degrade due to heat when the light is on for a long time. This causes not only
safety issues, but also reduces power efficiency and it is recommended to have regular maintenance and inspection.
- Cleaning and inspection should be performed at least once every 6 months.
- Inspection by a specialist, such as a product contractor, should be performed at least once every 3 years.
- If the apparatus is used for a long time without having an inspection, there is a small possibility that it could lead to
fuming, igniting, electric shock and the like.

Inspection Methods

- Is LED operating normally?
- Is there any unusual smell, sound or heat?
- Are there any cracks, splits, or detached parts on any parts or joints?

Cleaning Method

Lightly wipe the lighting apparatus with a soft cloth.

- To best clean the apparatus, wipe dirt with a soft cloth which has been soaked in a neutral detergent diluted with
water and wrung firmly. To finish off, wipe it with a damp cloth and dry it.

Product specifications

※unit of measure=mm

【LFPA20-0960-※-CL-I】

Front view

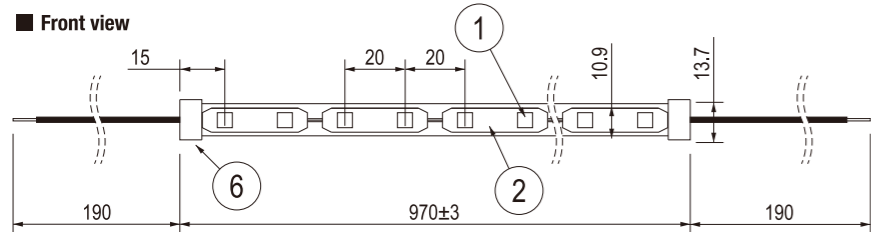

Side view 2



Side view 1

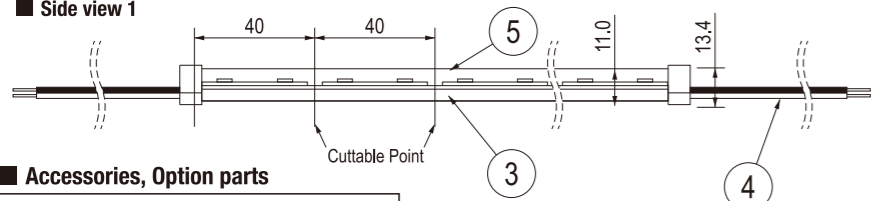

Accessories, Option parts

End cap (LFPA-EC 2pcs/1bag)
(2pcs attached upon request)

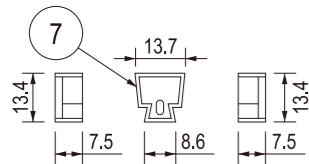

Option parts

Mounting rail 900 (LFPA-RL0900)

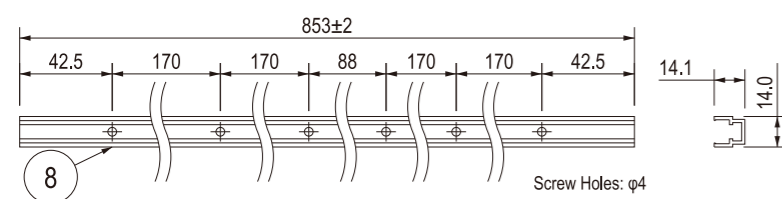

Mounting parts
(LFPA-RL0030 5pcs/1bag)

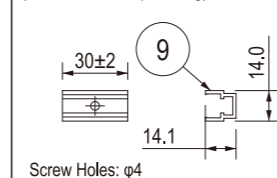

Mounting rail parts accessories :

Mounting clip
(LFPA-PT 5pcs/1bag)

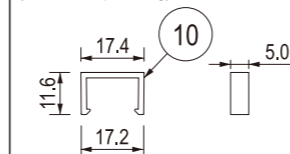

Item / Product Name	Luci Power FLEX α
Model No.	LFPA20-0960-※-CL-I
Power consumption	10W
Input current	440mA (max)
Number of LEDs	48 LED
Weight	60g
Environment	Indoors (No Condensation)
Operating temperature	0°C~+35°C (No Condensation)
Max. sets connectable	5 (5m portion)
Material (Body)	Soft acrylic
Min. allowable bend range	R300mm
Accessories	End cap × 2 (※upon request)
Option parts	Mounting rail, Mounting parts, Instant glue for mounting
Dimmable	○



Input voltage

DC24V

#	Item	Name Materials etc.
①	LED	SMD type
②	LED Substrate	FR-4 (base material)
③	Flexible Substrate	FPC
④	Lead Wire	Black+, White-
⑤	Body	Flexible Acrylic, Clear
⑥	Top cap	Polycarbonate, Clear
⑦	End cap	Polycarbonate, Clear
⑧	Mounting rail 900	AES
⑨	Mounting parts	AES
⑩	Mounting clip	Polycarbonate, Clear

Connecting lamp fittings

For 5 devices or less

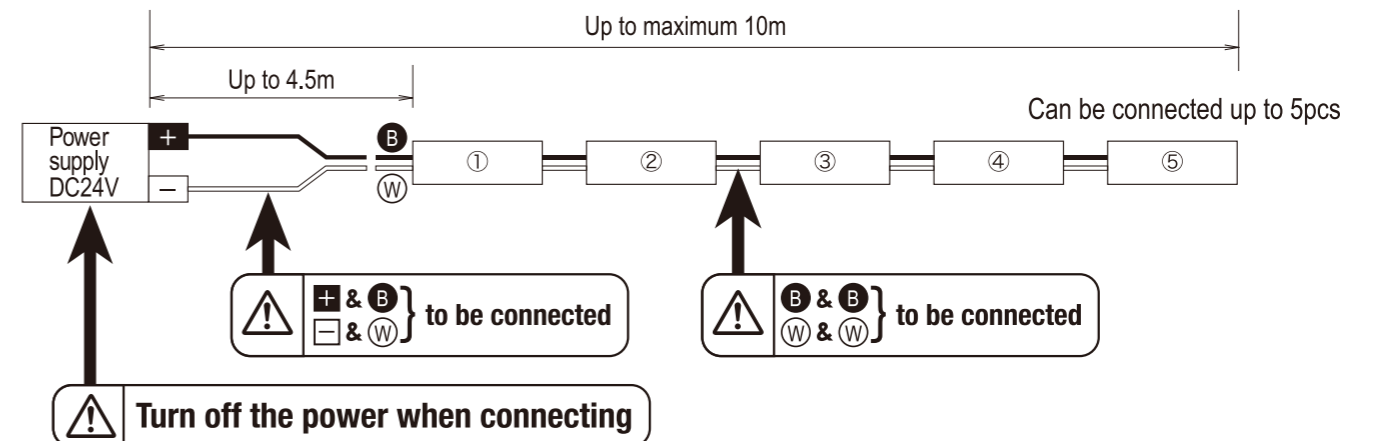

For 6 devices or more

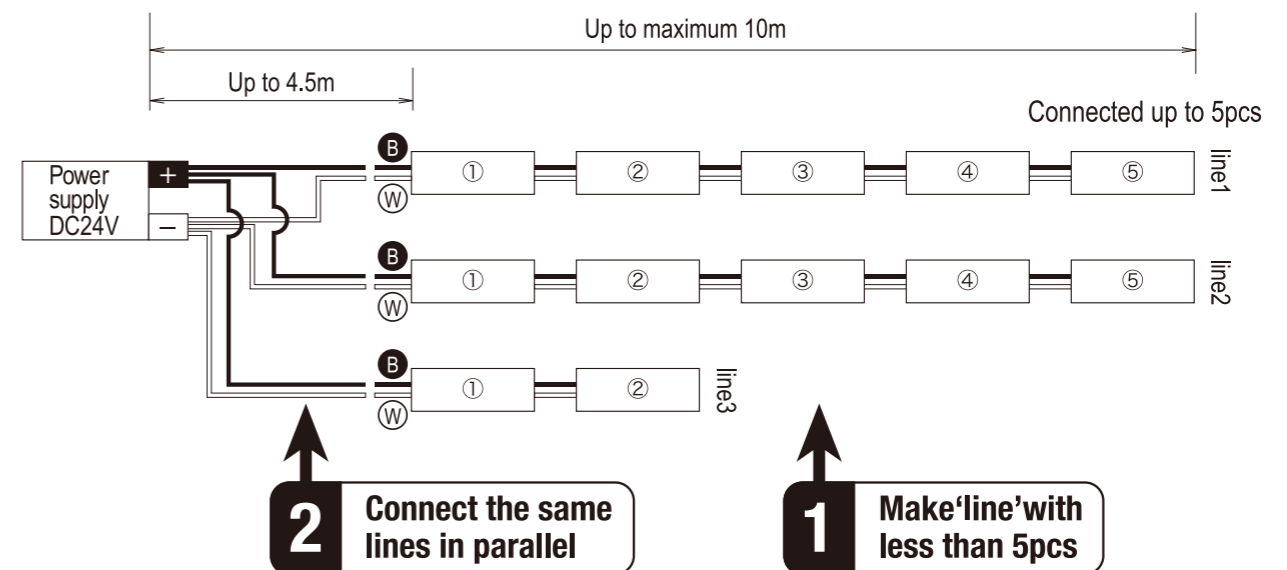

※Amount of the connecting device depends on the power output (W).

※Luci Power FLEX α can be connected up to 5pcs. The max distance between the power to the last device is 10m.

※Divide into multiple lines when the amount exceeds more than the max connectable units.

⚠ Cautions

- It is recommended to connect directly same lines. (diagram above)
- When connecting multiple lines into one, please connect less than 5 pcs*6 lines. (right diagram)

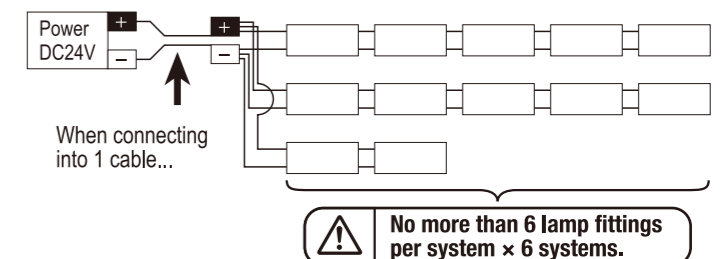

Cutting of lamp fitting

The lamp fitting can be shortened by cutting in increments of 2 LEDs.

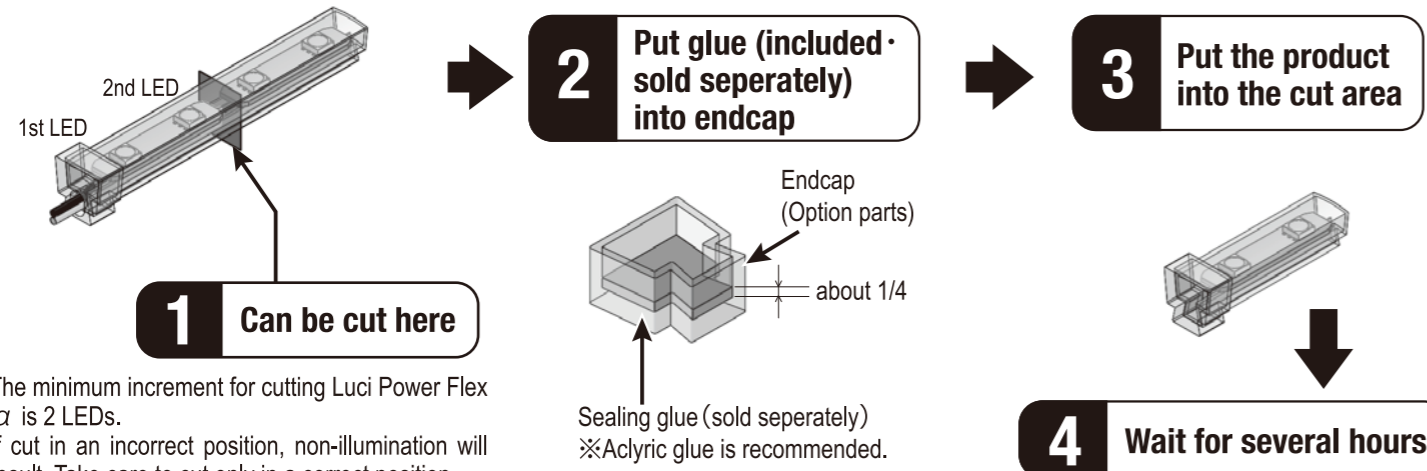

The minimum increment for cutting Luci Power Flex α is 2 LEDs.
If cut in an incorrect position, non-illumination will result. Take care to cut only in a correct position.

Installing the product See the attached paper.

Usage when flexed

Mounting with glue

Fix the mounting parts and the mounting clips in the necessary location, depending on the processing condition.

- Mounting parts for Power FLEX α (Model No : LFPA-RL0030)
- Mounting clip for Power FLEX α (Model No : LFPA-PT)
- screws (commercially available) (Screw hole 4mm dia.)

Mounting clip bundled with a rail

⚠ When mounting the light appliance upside down, be sure to use the clips. There is a risk of dropping.

Direct usage when flexed

Mounting with screws

Fix the mounting rail 900 and the mounting clips at the necessary location, depending on the processing condition.

- Mounting rail 900 for Power FLEX α (Model No : LFPA-RL0900)
- Mounting clip for Power FLEX α (Model No : LFPA-PT)
- screws (commercially available) (Screw hole 4mm dia.)

⚠ When mounting the light appliance upside down, be sure to use the clips. There is a risk of dropping.

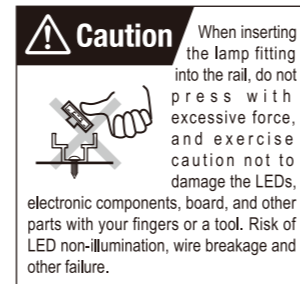
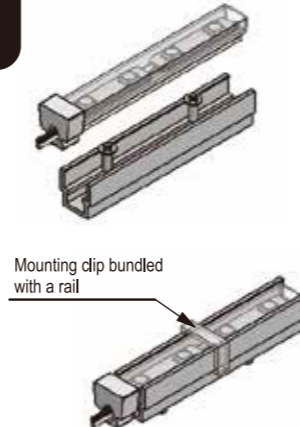

Important points for rail mounting

⊘ Do not push lengthwise into the rail

Caution! If tension is applied for an extended period in the horizontal direction, non-illumination due to circuit breakage and other damage to the lamp fitting may occur.

- If you are inserting a tube into the rail, insert the side that is least thick first. (Note1)
- Do not use a roller or other tool to insert by pressing and extending the tube lengthwise along the rail.
- When inserting the tube, press down perpendicular to the rail on the thickest side of the tube with your thumb.
- The tube is a soft material. Do not apply stress to the top surface on which the LEDs are attached.
- To remove the tube, insert your finger between the rail and tube and gently detach the tube.

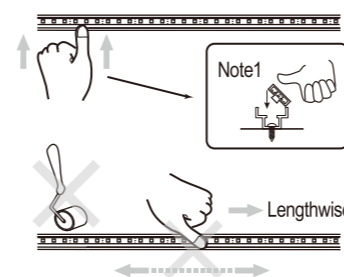

Connecting to the power supply

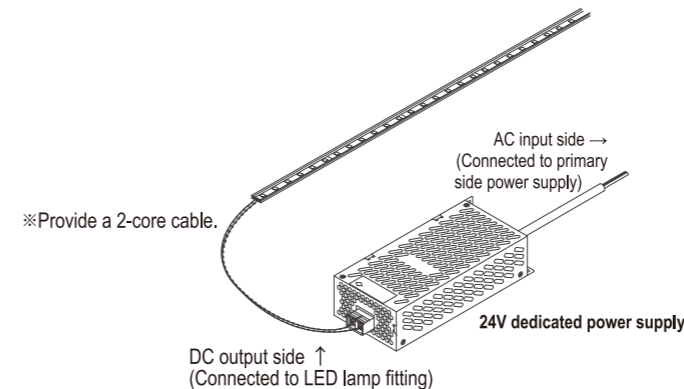

Ex: 150W dedicated power supply connection section details

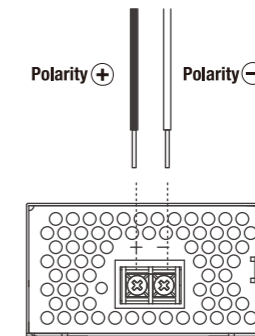

- When wiring, make your selection by paying careful attention to the cable used at the input and output. When current flows in a long cable, the loss (heat generation) is generated by resistance, etc.
- When the cable is bundled, heat dissipation becomes poor and the temperature becomes extremely high. When bundling 5 cables or more, connect by lowering the load factor (number of connected devices).